

EASYWork



Tap-N-Go Trimmer Head Ø109

Easiest Fastest Strongest

NEW

PATENT PENDING

Ø109



Tap-N-Go double line head Ø109 mm.
Combines the Tecomec traditional operation reliability with an outstanding and **innovative line loading system**.
Sturdy construction confirmed by the heaviest internal and severe OEM's field tests.
Fit the most brushcutters on the market.

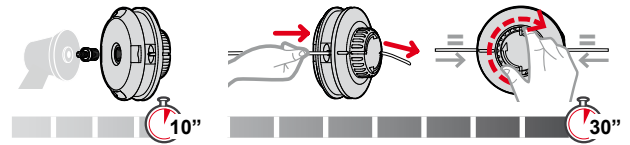

► highlights



Easy and fast mounting on every type of brushcutter.



Refilling without disassembling any part of the trimmer head.

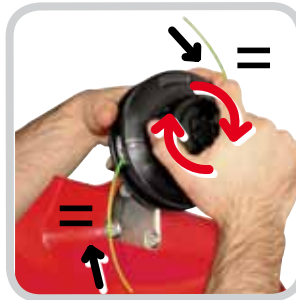

Line loading in 30".

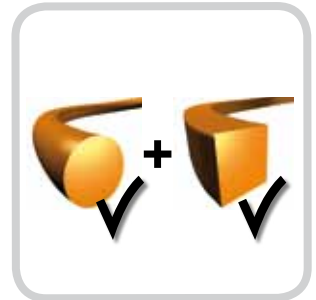

Can be charged with round and square line.



Shaped steel line retainers, to avoid breakage of the line during the work.



Locking hooks head outside the working area of the line.



Reinforced knob and easy to handle. High capacity of line.







Easy opening of the head for maintenance and cleaning.

► features

Use	Suitable for	Line Length	Max Line Size	Max RPM	Weight	Single Pack	Master Pack																																				
 Ideal for: grass and large weeds, also around obstacles	 All brushcutters 25-33 cc	 <table border="1"> <thead> <tr> <th>mm</th> <th>in</th> <th>m</th> <th>ft.</th> </tr> </thead> <tbody> <tr> <td>1,6</td> <td>.065"</td> <td>11,0</td> <td>36,09</td> </tr> <tr> <td>2,0</td> <td>.080"</td> <td>6,5</td> <td>21,33</td> </tr> <tr> <td>2,4</td> <td>.095"</td> <td>5,5</td> <td>18,05</td> </tr> <tr> <td>2,7</td> <td>.105"</td> <td>4,2</td> <td>13,78</td> </tr> <tr> <td>3,0</td> <td>.119"</td> <td>3,1</td> <td>10,17</td> </tr> </tbody> </table>	mm	in	m	ft.	1,6	.065"	11,0	36,09	2,0	.080"	6,5	21,33	2,4	.095"	5,5	18,05	2,7	.105"	4,2	13,78	3,0	.119"	3,1	10,17	 <table border="1"> <thead> <tr> <th>mm</th> <th>in</th> </tr> </thead> <tbody> <tr> <td>3,0</td> <td>119"</td> </tr> </tbody> </table>	mm	in	3,0	119"	 <table border="1"> <thead> <tr> <th>min⁻¹</th> </tr> </thead> <tbody> <tr> <td>10000</td> </tr> </tbody> </table>	min ⁻¹	10000	 <table border="1"> <thead> <tr> <th>kg</th> </tr> </thead> <tbody> <tr> <td>0,34</td> </tr> </tbody> </table>	kg	0,34	 <table border="1"> <thead> <tr> <th>PCS</th> </tr> </thead> <tbody> <tr> <td>1</td> </tr> </tbody> </table>	PCS	1	 <table border="1"> <thead> <tr> <th>PCS</th> </tr> </thead> <tbody> <tr> <td>20</td> </tr> </tbody> </table>	PCS	20
mm	in	m	ft.																																								
1,6	.065"	11,0	36,09																																								
2,0	.080"	6,5	21,33																																								
2,4	.095"	5,5	18,05																																								
2,7	.105"	4,2	13,78																																								
3,0	.119"	3,1	10,17																																								
mm	in																																										
3,0	119"																																										
min ⁻¹																																											
10000																																											
kg																																											
0,34																																											
PCS																																											
1																																											
PCS																																											
20																																											

versions

P/N				
50729004	EW Ø109	Round Line	M10x1,25 LH F	M8x1,25 LH M
50729005	EW Ø109	Round Line	M10x1 LH F M12x1,5 LH F	/
50729003	EW Ø109	Round Line	NEUTRAL delivered without adaptor (to be ordered separately)	

ORDER MULTIPLES OF: 20 pcs

L
A
R
T
I
C
O
L
E

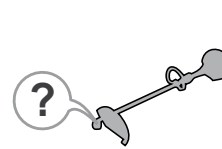

Identify your gear case.

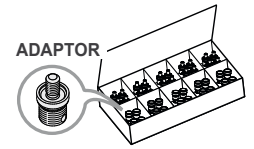

Choose the correct adaptor from Tecomec Adaptors Box (P/N K00401044)



Fit the adaptor on the head

packaging

Single Pack (1 PC)



- TOP**
- Type of adaptor
 - EAN code
 - Part No.
- BACK**
- Mounting instructions
 - Loading instructions
 - Technical data

Q.TY x PACK: 1 pc
DIMENSION: 11,5X7,3X11,5 cm
TOTAL WEIGHT: 0,4 kg

Master Pack (20 PCS)



- FRONT**
- Part No.
 - Brushcutter mark and model list
- LEFT/RIGHT SIDE**
- Mounting instructions
 - Filling & Loading instructions
 - Technical data

Q.TY x MASTER PACK: 20 pcs
DIMENSION: 24X24X37 cm
TOTAL WEIGHT: 8,2 kg

Tecomec Adaptors Box

P/N	Adaptors Box
K00401044	Adaptors Box
PACKAGING:	Plastic Box
Q.TY x MASTER PACK:	1 pc
TOTAL WEIGHT:	2,0 kg
ORDER MULTIPLES OF:	1 pc



- M 8x1,25 LH F (10 PCS)
- M 10x1,5 LH F (10 PCS)
- M 12x1,25 LH F (10 PCS)
- M 10x1,25 LH M (10 PCS)
- M 10x1,5 LH M (10 PCS)
- M 7x1 LH M (10 PCS)
- 3/8 - 24F LH F (10 PCS)
- M 12x1,75 LH F (10 PCS)
- M 14x1,5 LH F (10 PCS)

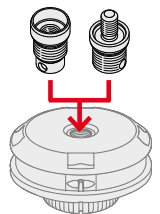

A complete range of adaptors allow to fit every type of brushcutter

9 different type of adaptors / 90 pcs in total

spare parts

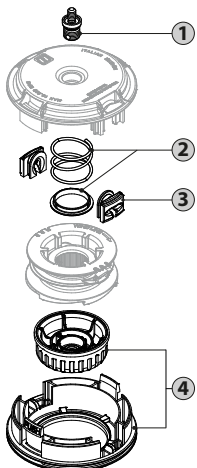

P/N	DESCRIPTION	ORDER MULTIPLES OF:
1 K00401045	Adaptor M 7x1 LH M	10 PCS
K00401061	Adaptor M 8x1,25 LH M	10 PCS
K00401046	Adaptor M 8x1,25 LH F	10 PCS
K00401047	Adaptor M 10x1 LH F	10 PCS
K00401048	Adaptor M 10x1,25 LH M	10 PCS
K00401062	Adaptor M 10x1,25 LH F	10 PCS
K00401049	Adaptor M 10x1,5 LH M	10 PCS
K00401050	Adaptor M 10x1,5 LH F	10 PCS
K00401051	Adaptor M 12x1,25 LH F	10 PCS
K00401052	Adaptor M 12x1,5 LH F	10 PCS
K00401053	Adaptor M 12x1,75 LH F	10 PCS
K00401054	Adaptor 3/8 - 24F LH F	10 PCS
2 K00401081	Spring kit	10 PCS
3 K00401055	Line retainer	10 PCS
4 K00401082	Cover + spool kit	10 PCS

Suitable to refill Tecomec Adaptors Box

